

The Township of



Rideau Lakes

**Ronald E Holman Complex Roof
Repairs - ADDENDUM #1**

A1-PW2026-11

A1-PW2026-11

This addendum is being released to clarify, revise, and supersede information in the Specification and Drawings for RFP PW2026-11 for roof repairs at the Ronald E Holman Complex. This Addendum also includes a revised roof plan. Please see attachment entitled "Ronald E Holman Roof Plan – Revised".

SUBJECT: ADDENDUM 1

BUILDING OWNER: TOWNSHIP OF RIDEAU LAKES

PROJECT: ROOF REPAIRS & MAINTENANCE
PW2026-11

OWNER'S REPRESENTATIVE: RYAN KINCH
GARLAND CANADA INC.
rkinch@garlandinc.com

DATE: April 1st, 2026

NOTICE TO BIDDERS: This Addendum is issued to all potential bidders. This addendum serves to clarify, revise, and supersede information in the Specification and Drawings. The Bidder shall acknowledge receipt of this Addendum in the appropriate space on the Bid Form.

- Add: caulk all windows on the clear storey on 3 sides (sides and bottom) at the transition from flat stock metal flashing to window units. All 4 sides of the clear storey to be completed.
- Remove and dispose of the ballasted antenna along with all anchor cables, ballast, wood, etc. Where the antenna was sat on the roof, apply new cold applied flood coat and embed pea gravel.
- Along the East scupper edge of roof 4.0 repair the membrane flashing along the entire East edge. Re&re the existing metal flashings. Remove existing loose flashing membranes. Spud, clean and prime 12” into the field of the roof. Install new 1 ply mineral cap flashings in cold adhesive leading 10” into the field of the roof and over the outside edge. Reflash the scuppers. 3 course all flashing seams and coat with aluminized coating. Install new cold flood coat and pea gravel up to the roof edge covering the field transition of the flashing membrane.
- Supply and install new trough, downspout and 8’ leader away from the building in area outlined on the photo below. To match adjacent roof section.
- Revised roof plan shown below and attached:

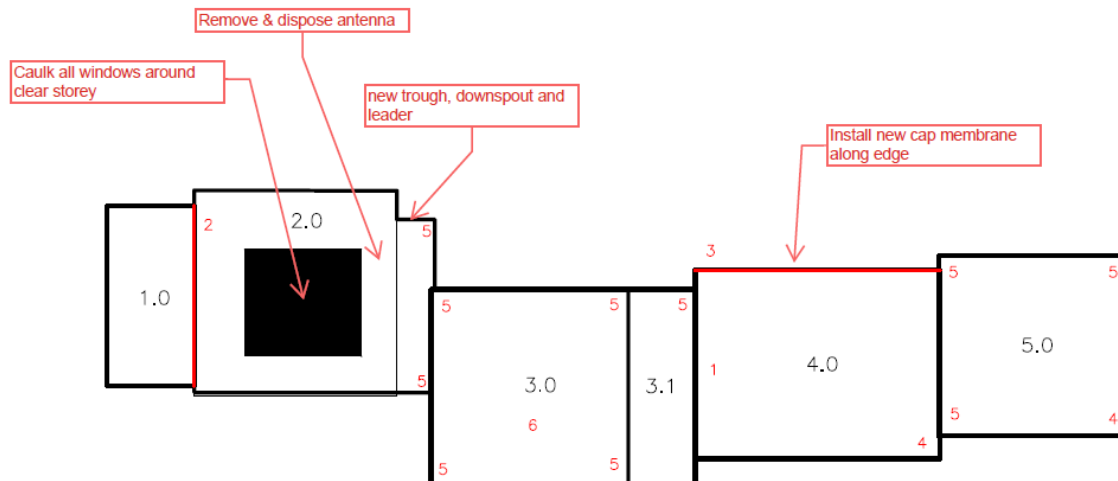



VIEW OF WINDOWS ON CLEAR STORY TO BE CAULKED



VIEW OF BALLASTED ANTENNA TO BE REMOVED & DISPOSED



VIEW OF ROOF EDGE TO BE REPAIRED



VIEW OF ROOF EDGE TO RECEIVE NEW
EAVESTROUGH AND DOWNSPOUT